



# Our Redevelopment Plans

## Watford General Hospital

### Key

1. New hospital building
2. Existing AAU building repurposed as admin/training centre
3. New multi-storey car park
4. Cycle hub
5. Potential site for Mount Vernon Cancer Centre
6. Admin block
7. Future expansion zone (New Acute Hospital)
8. Watford football stadium
9. New energy centre

-  Visitor vehicle access
-  Visitor entrance
-  Ambulance entrance

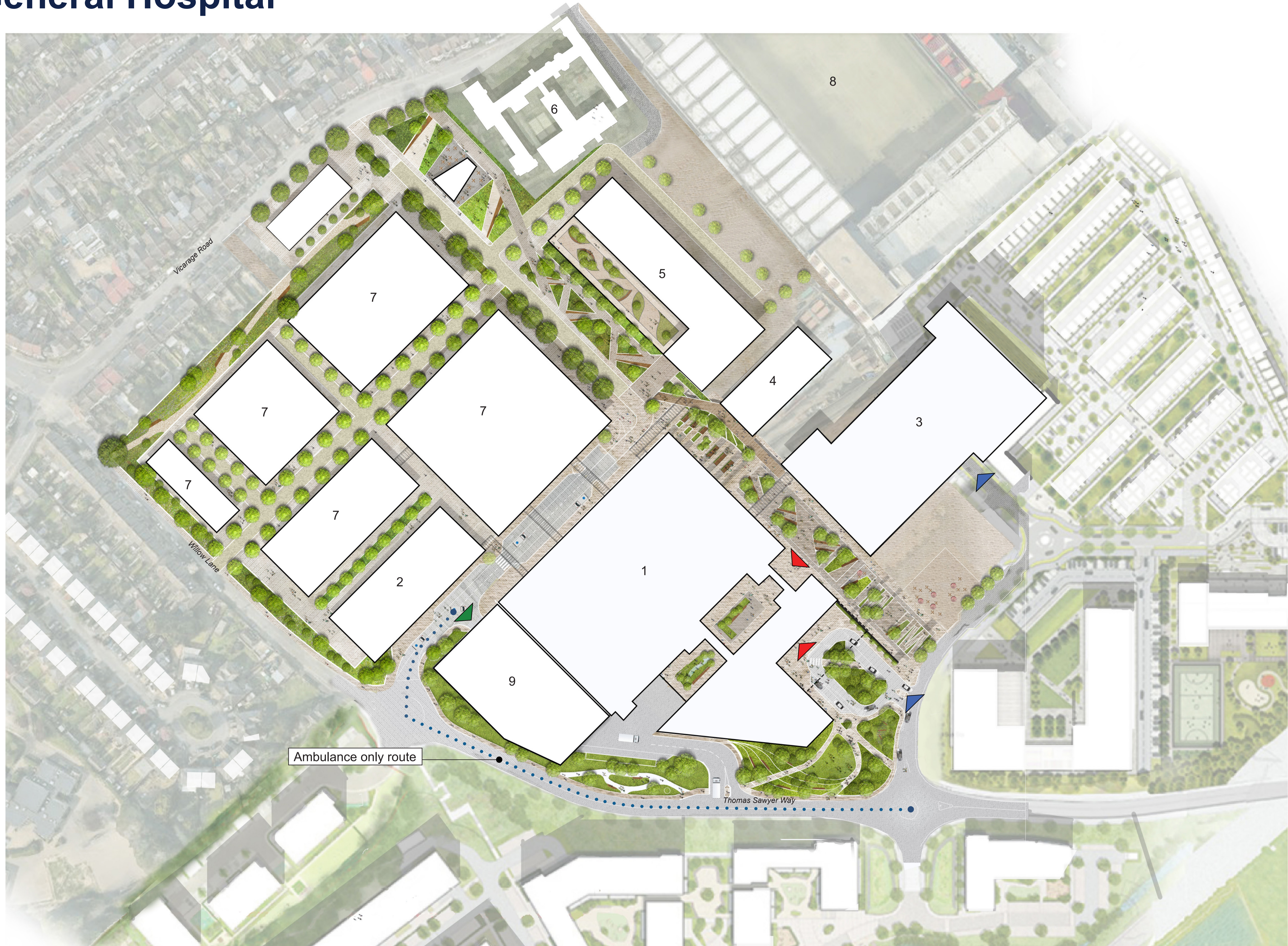



# Our Redevelopment Plans

## Watford General Hospital

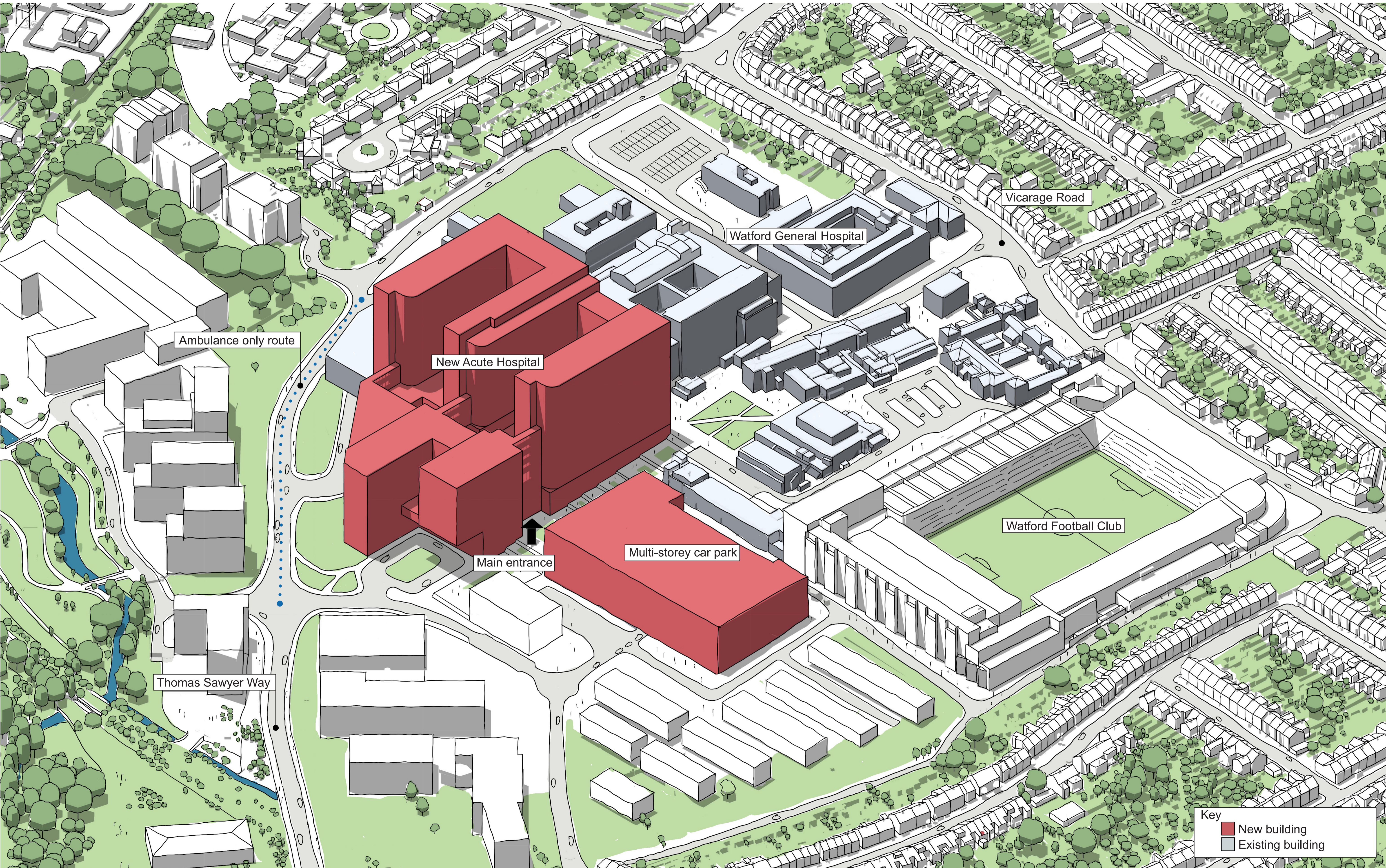



# Our Redevelopment Plans Watford General Hospital

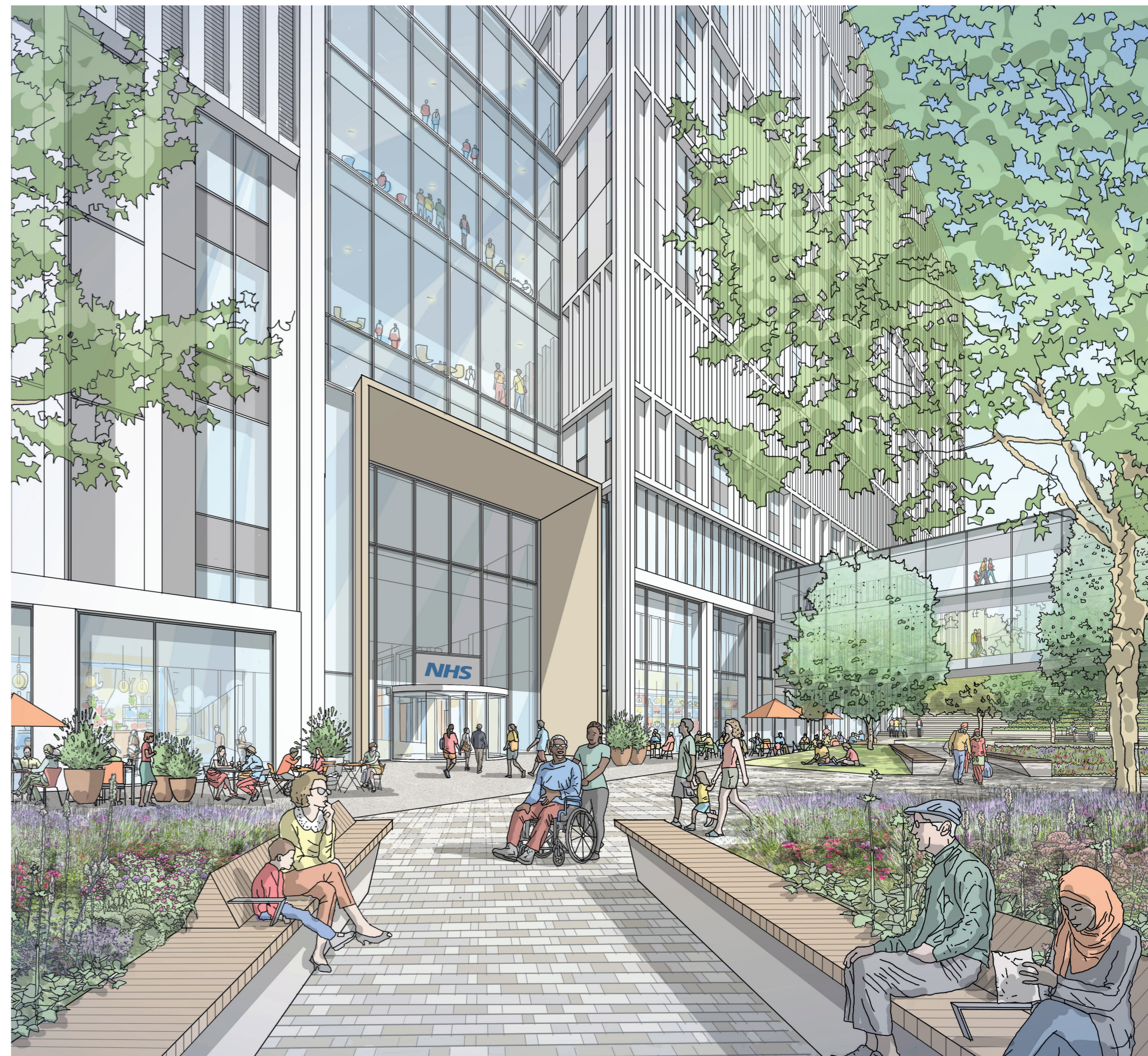



# Our Redevelopment Plans Watford General Hospital

Ground to third floor

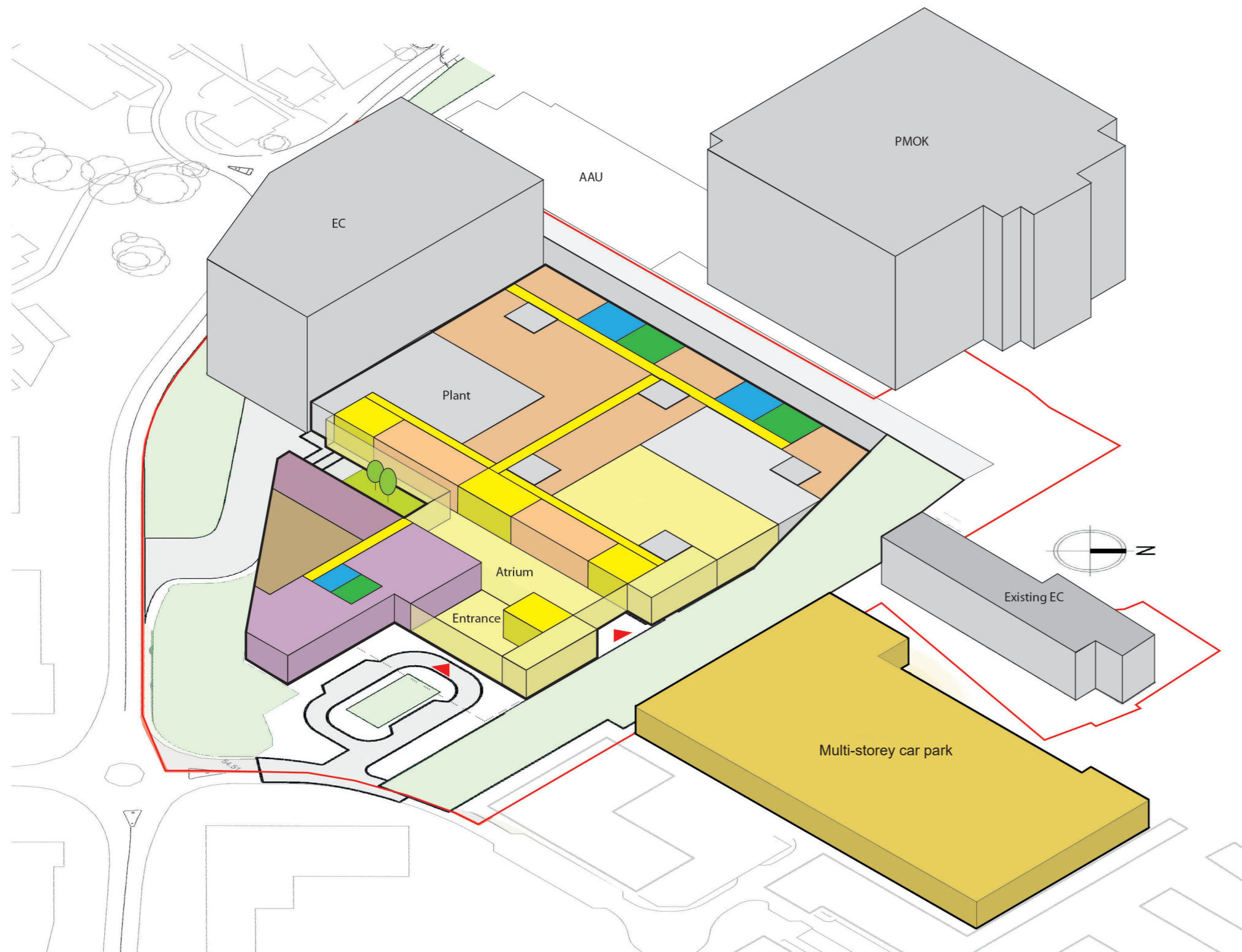
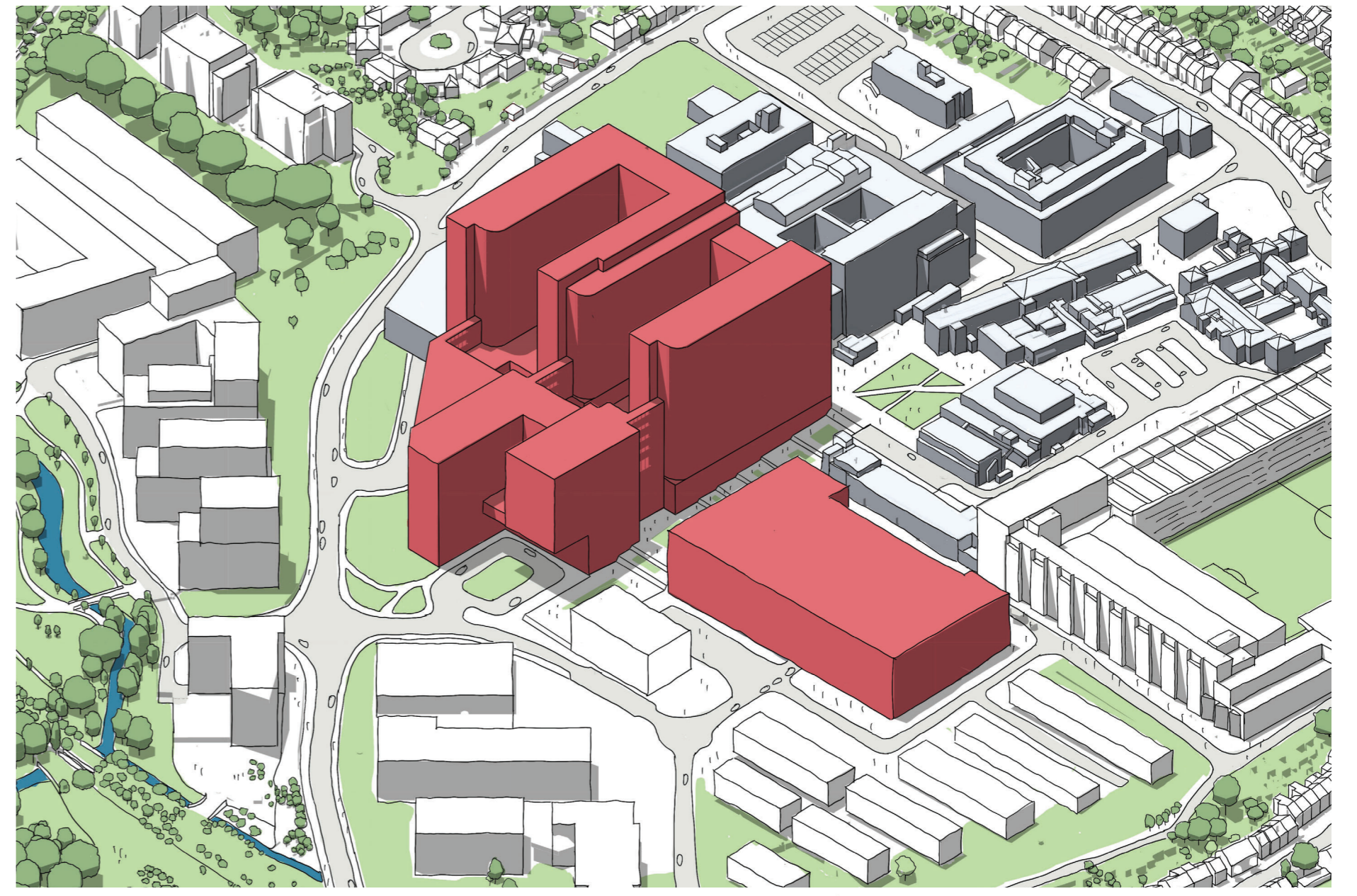

Ground floor - Support Services

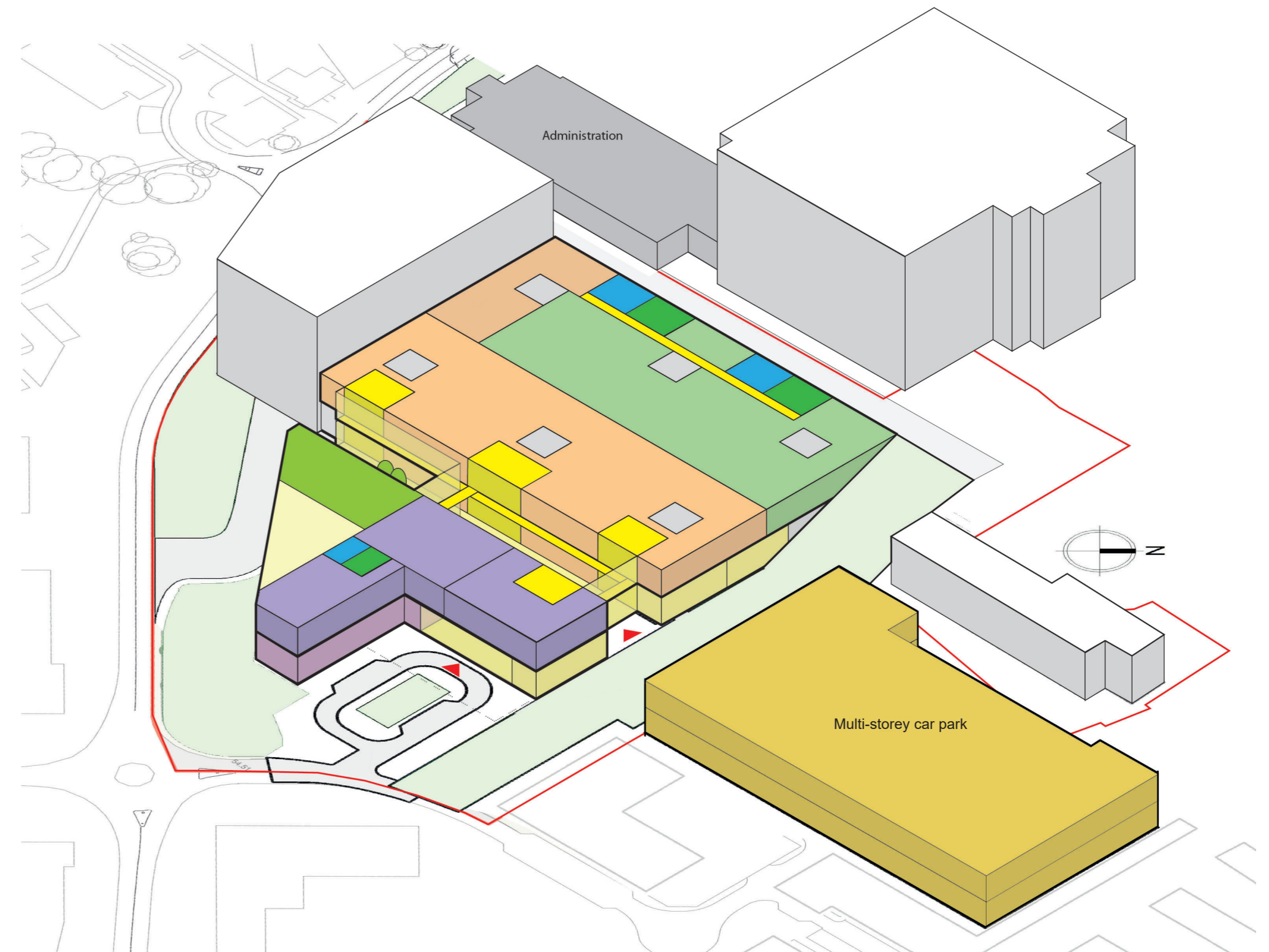

First floor - Diagnostics & Outpatients

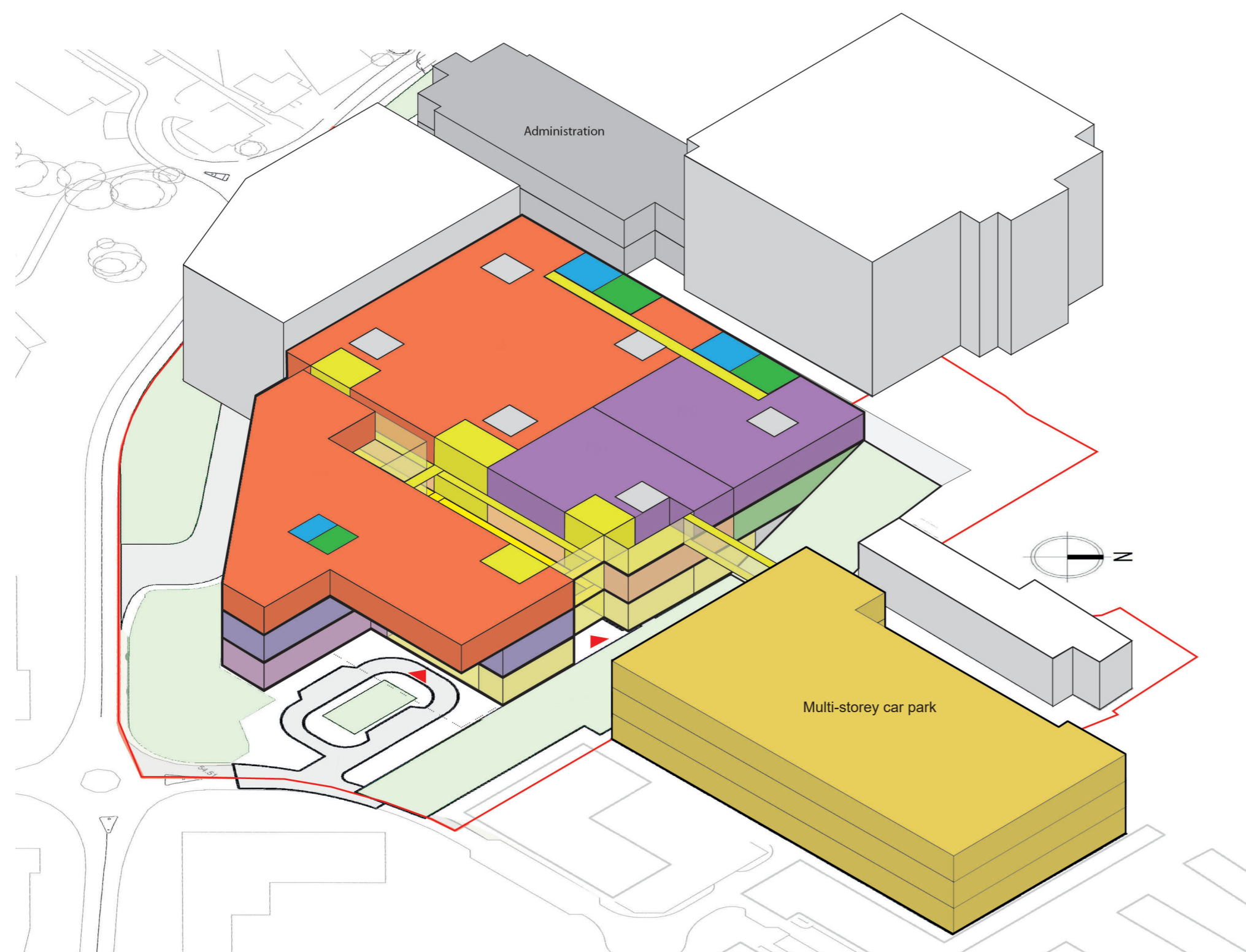

Second floor - Emergency Department

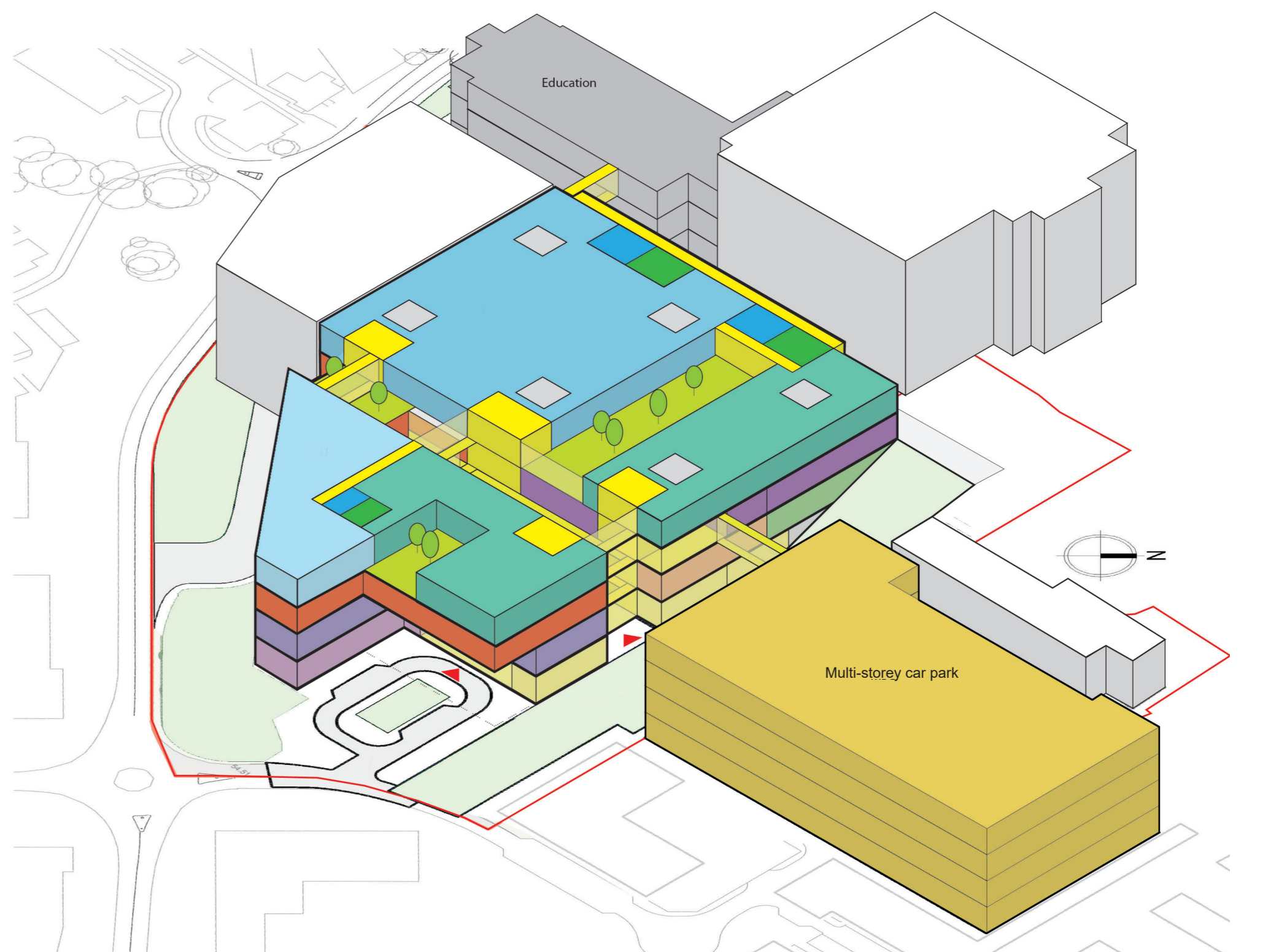

Third floor - Critical Care incl. Theatres

## Key

- |                     |                          |                               |                           |
|---------------------|--------------------------|-------------------------------|---------------------------|
| Services            | Women's + Children's OPD | Operating Theatres            | Specialist services       |
| Catering            | Diagnostics              | Intensive Care Unit           | Inpatient wards           |
| Pharmacy            | Offices                  | Cardiology ward               | New multi-storey car park |
| Estates             | Chemotherapy             | Cath Labs                     |                           |
| Mortuary            | Emergency Adult          | Plant                         |                           |
| Outpatient services | Emergency Children       | Women's + Children's services |                           |



# Our Redevelopment Plans Watford General Hospital

Fourth to fourteenth floor

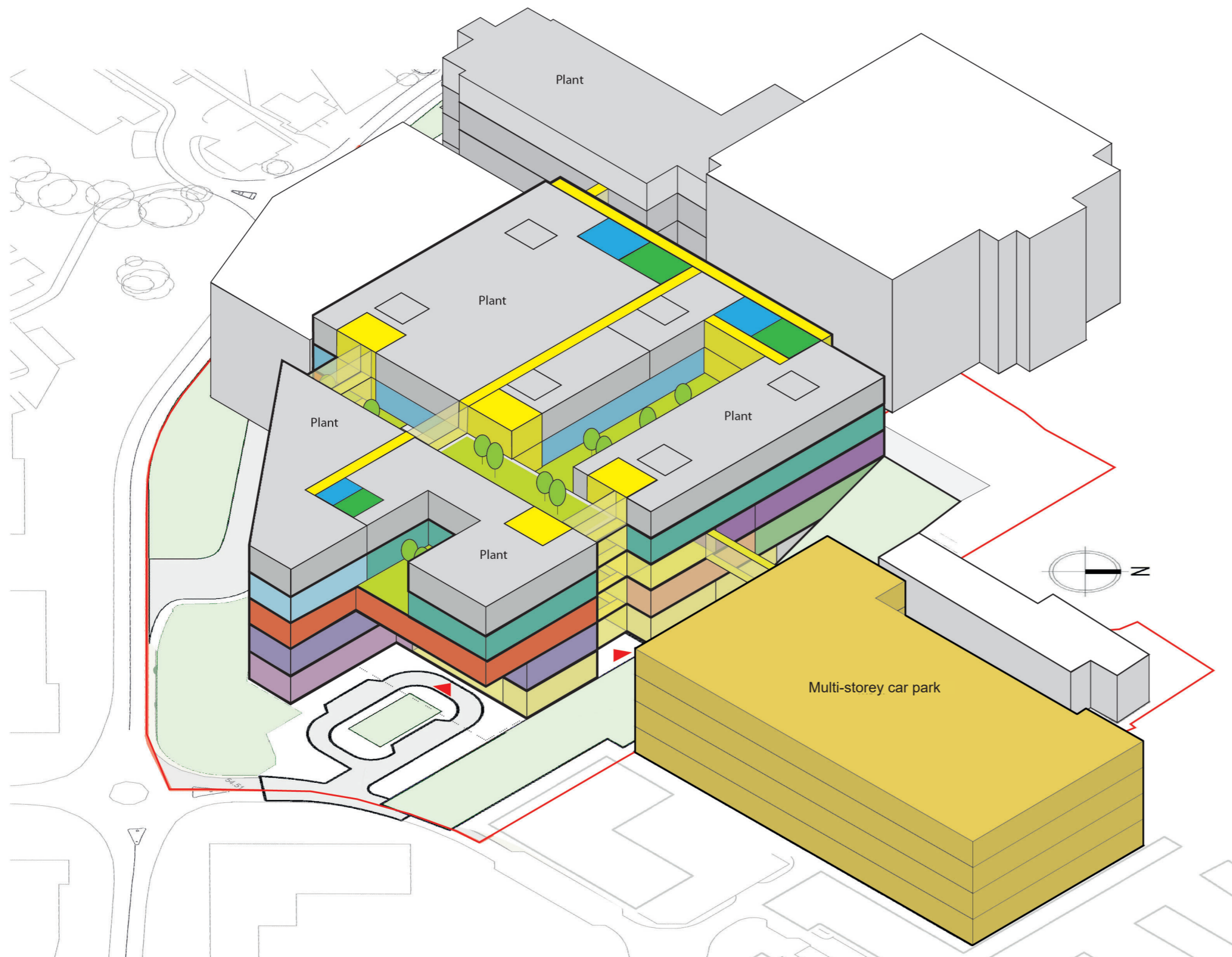
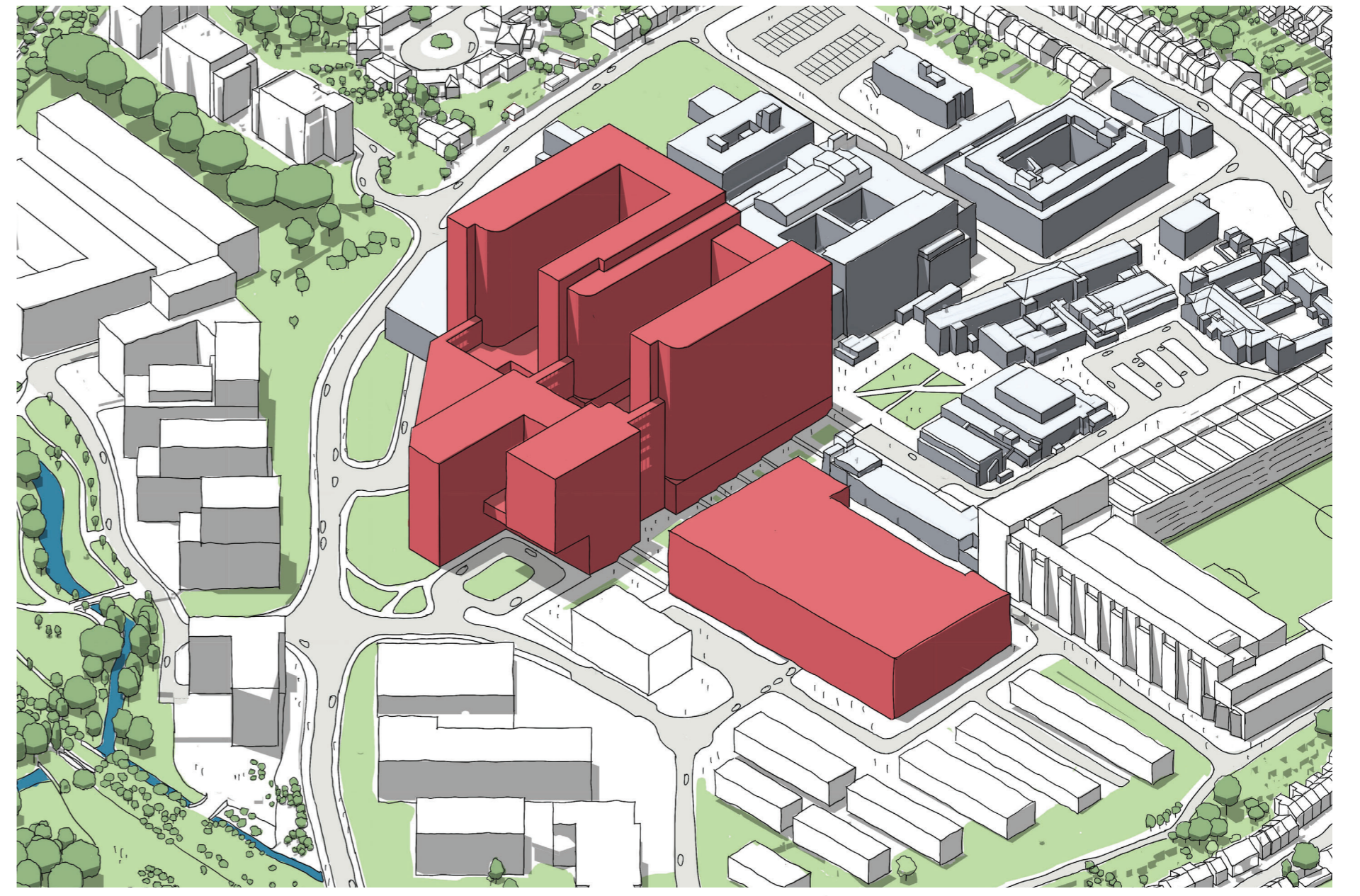

Fourth floor - Engineering Plant & Services

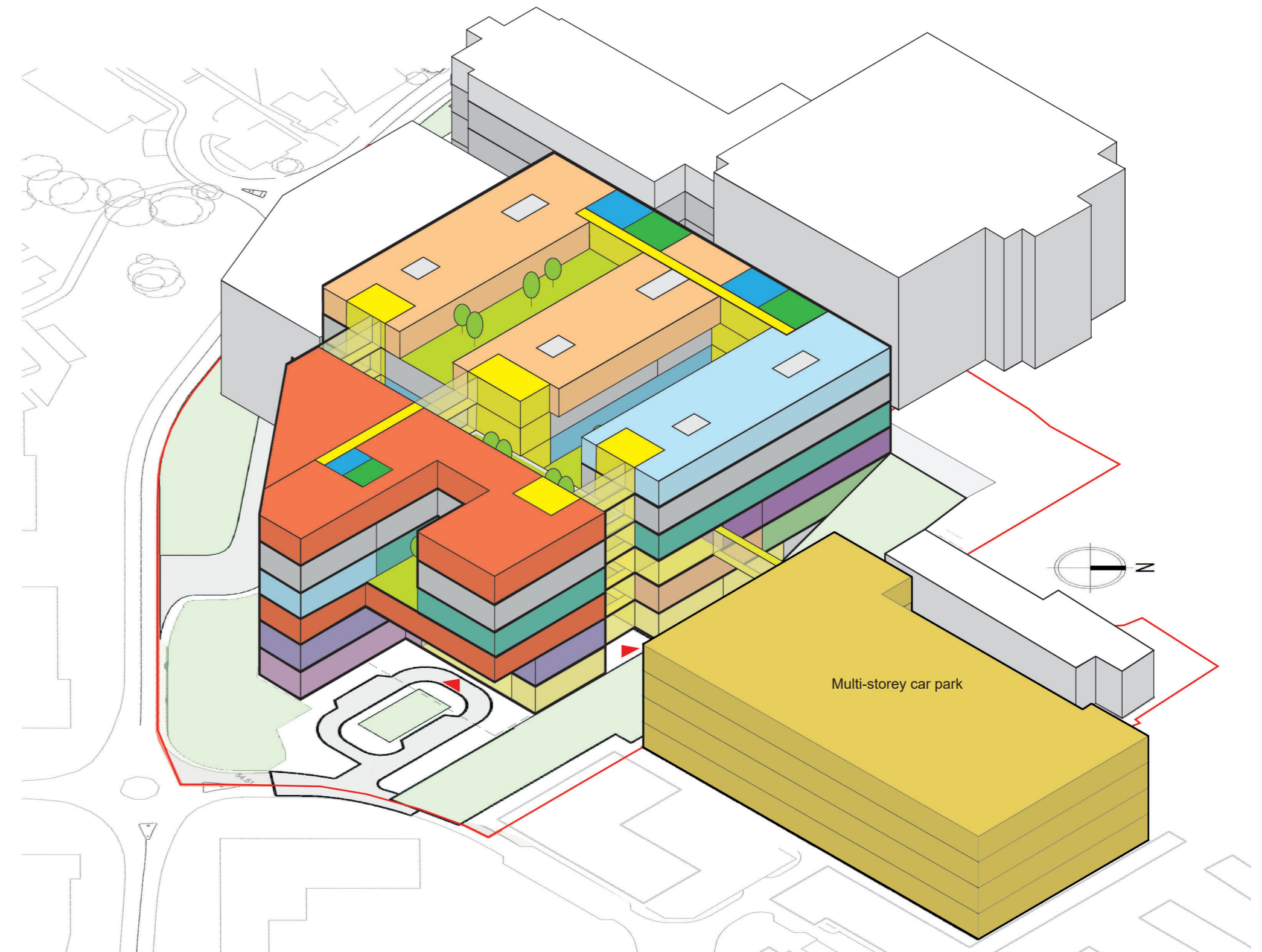

Fifth floor - Emergency Care & Specialist Wards

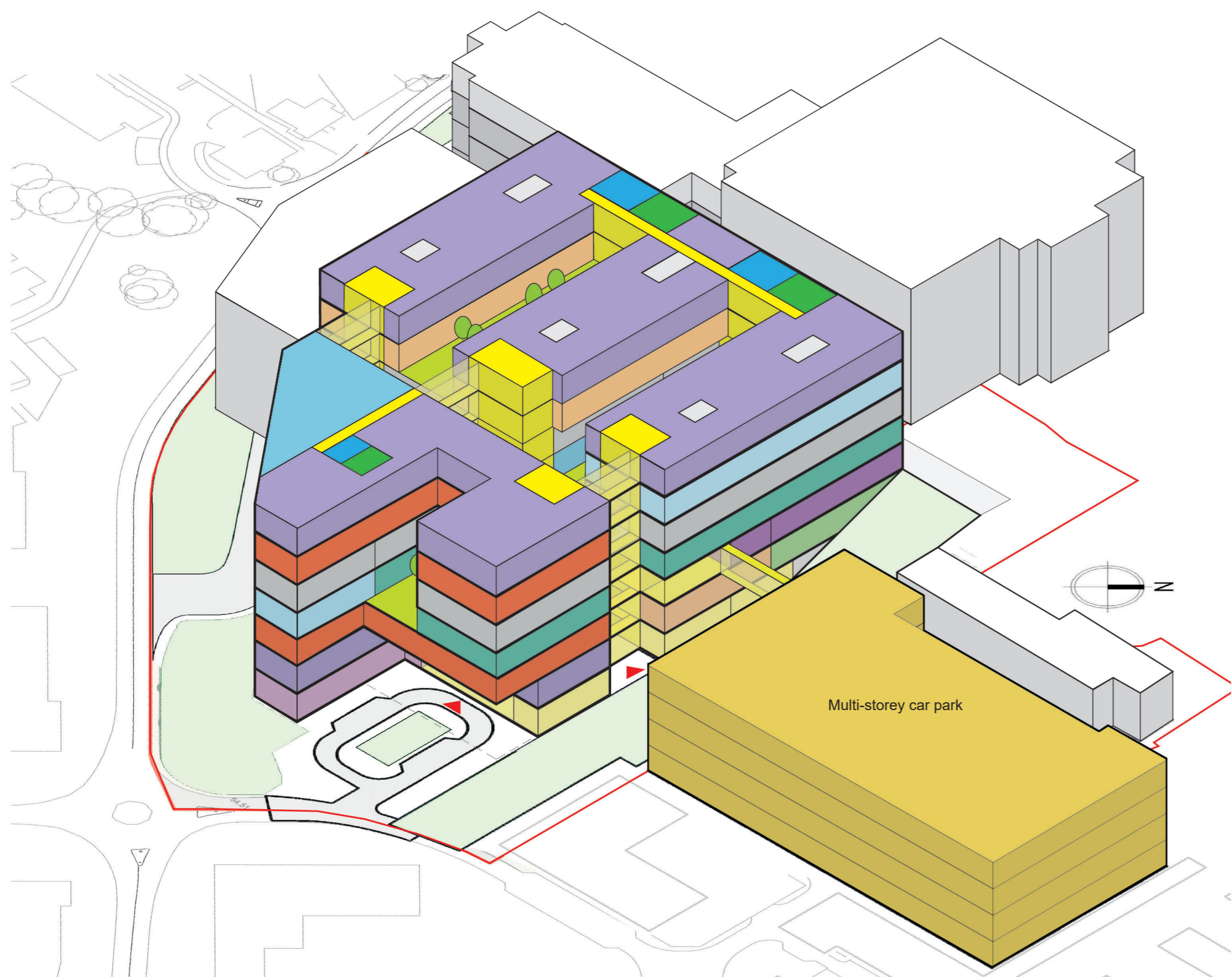

Sixth floor - Women's & Children's Services

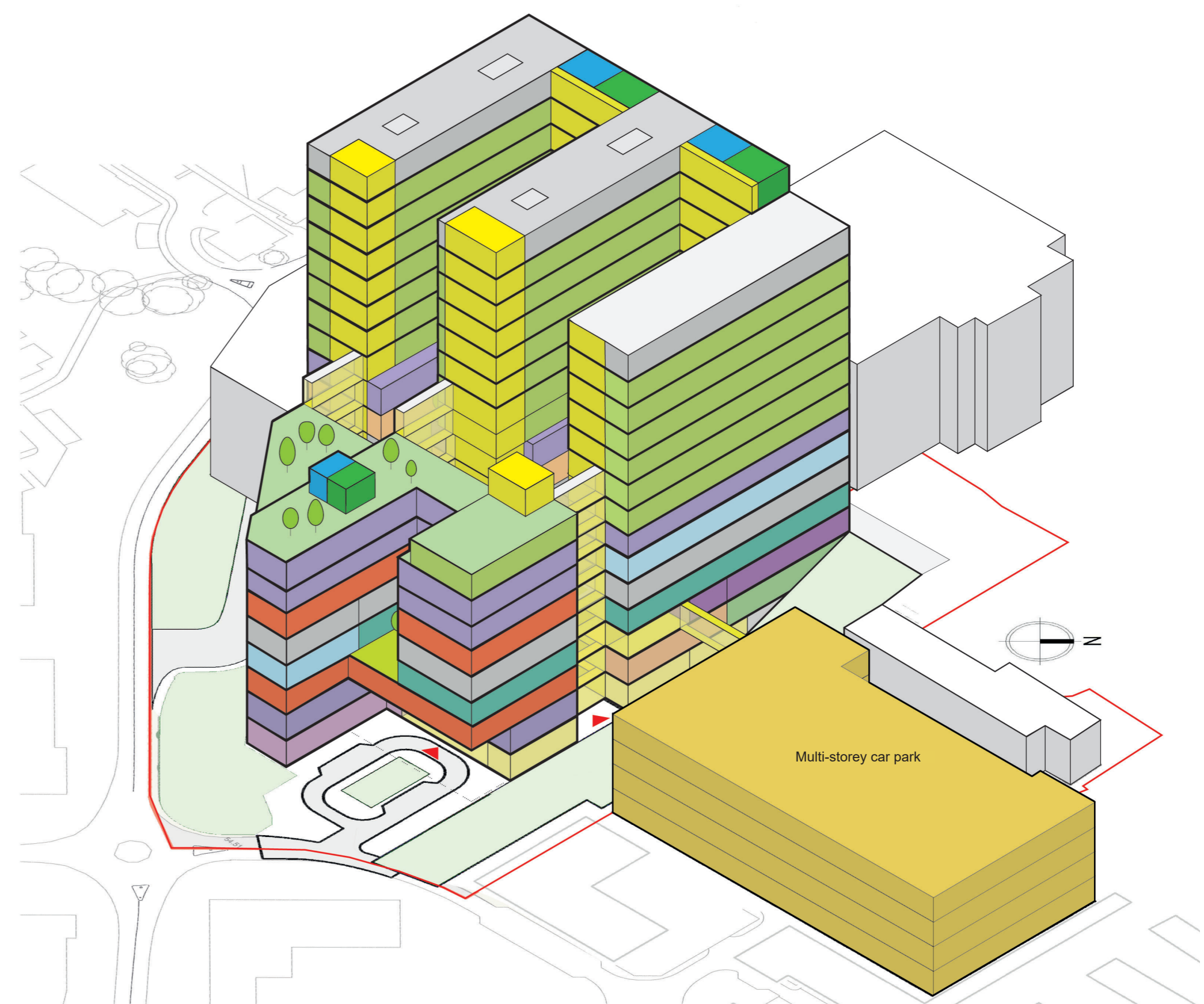

Seventh to Fourteenth floor - Inpatient Wards

Key

Services	Women's + Children's OPD	Operating Theatres	Specialist services
Catering	Diagnostics	Intensive Care Unit	Inpatient wards
Pharmacy	Offices	Cardiology ward	New multi-storey car park
Estates	Chemotherapy	Cath Labs	
Mortuary	Emergency Adult	Plant	
Outpatient services	Emergency Children	Women's + Children's services	



# Our Redevelopment Plans

## Watford General Hospital

Short-list Options  
Architect's Illustration

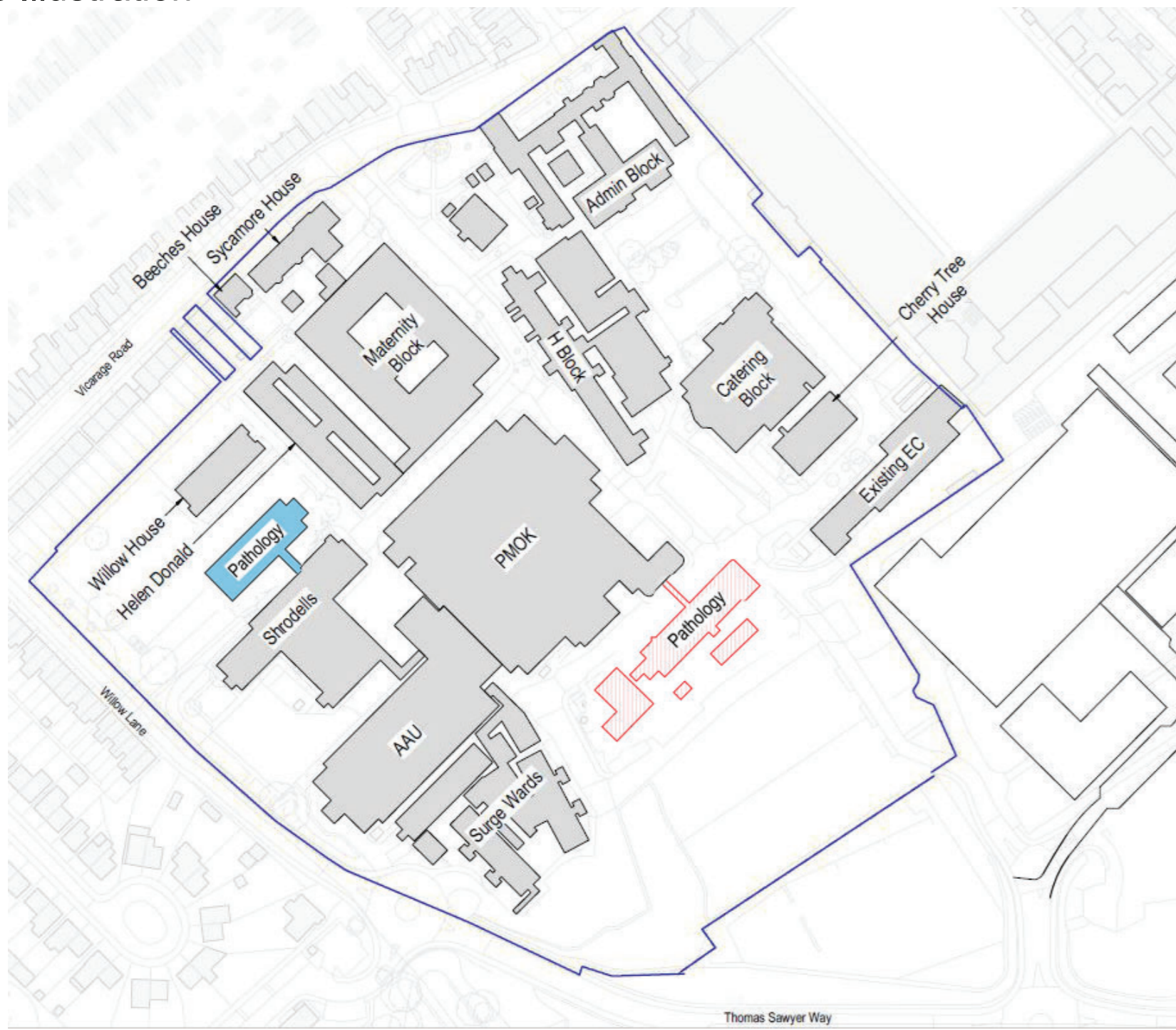

Option 1



Option 2



Option 3



Option 4



Option 5



Option 6



# Our Redevelopment Plans

## Hemel Hempstead Hospital



**Indicative 3D models**  
New facilities

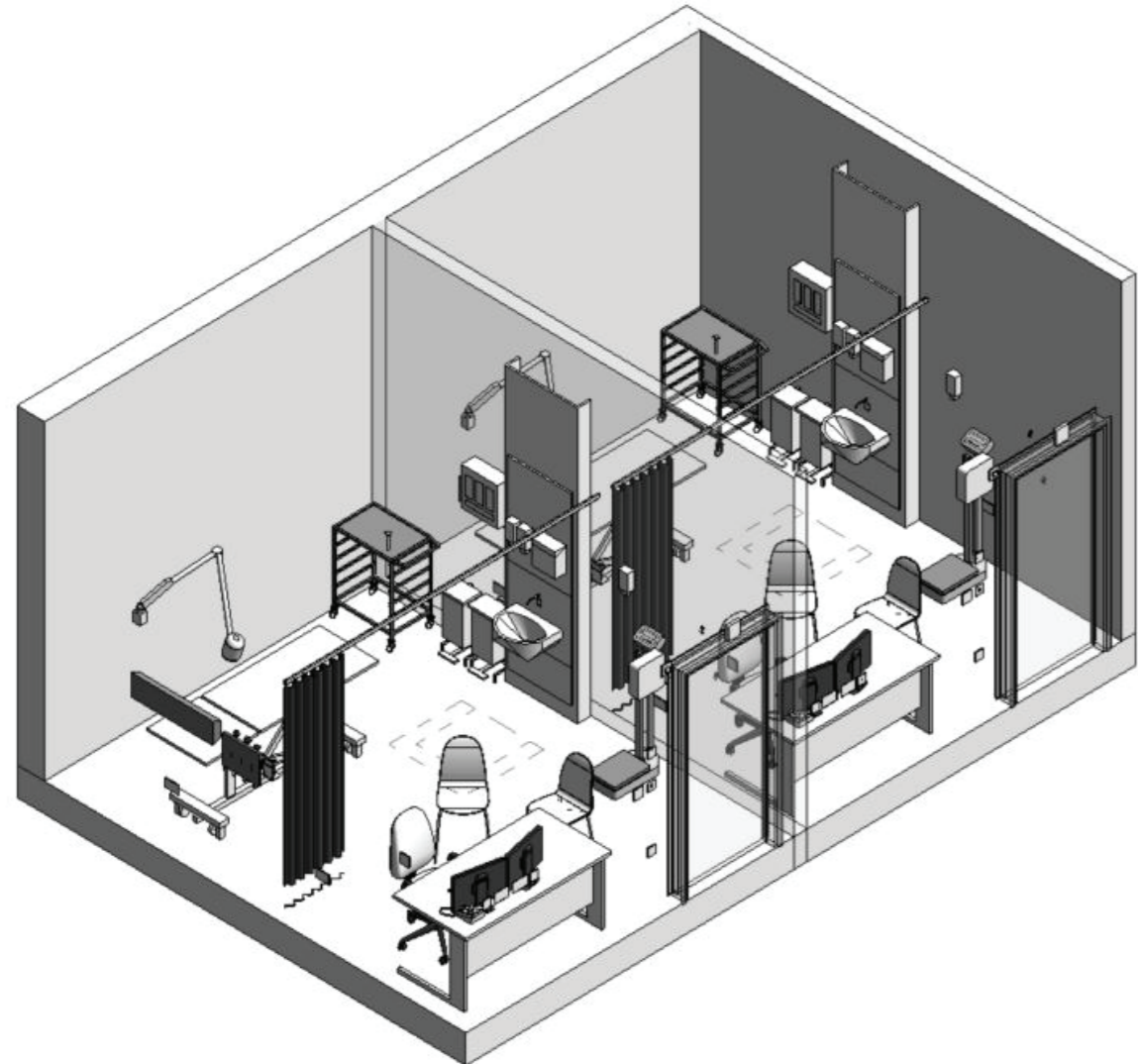

Model for New Consulting and Treatment rooms

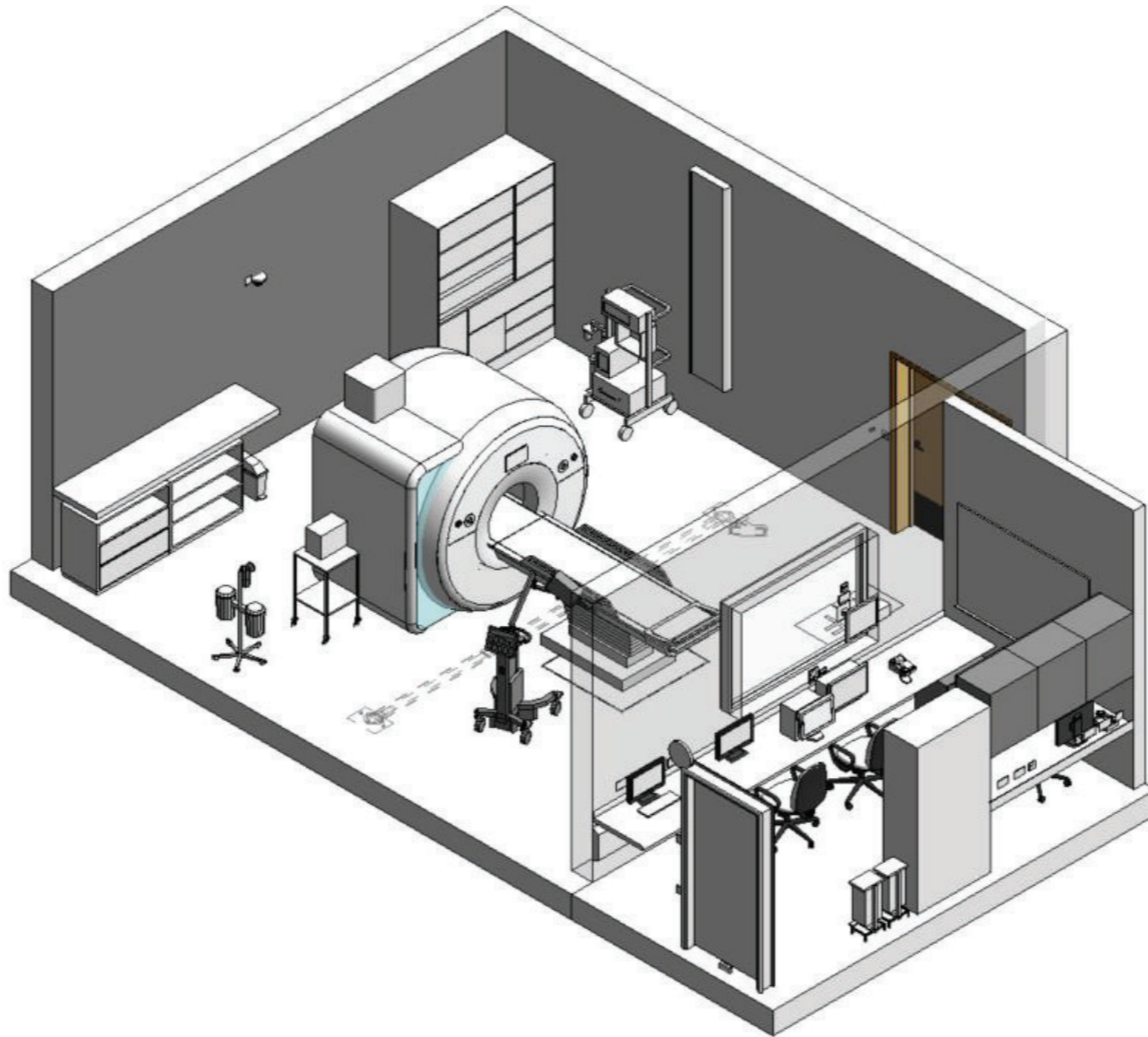

New Diagnostic Centre

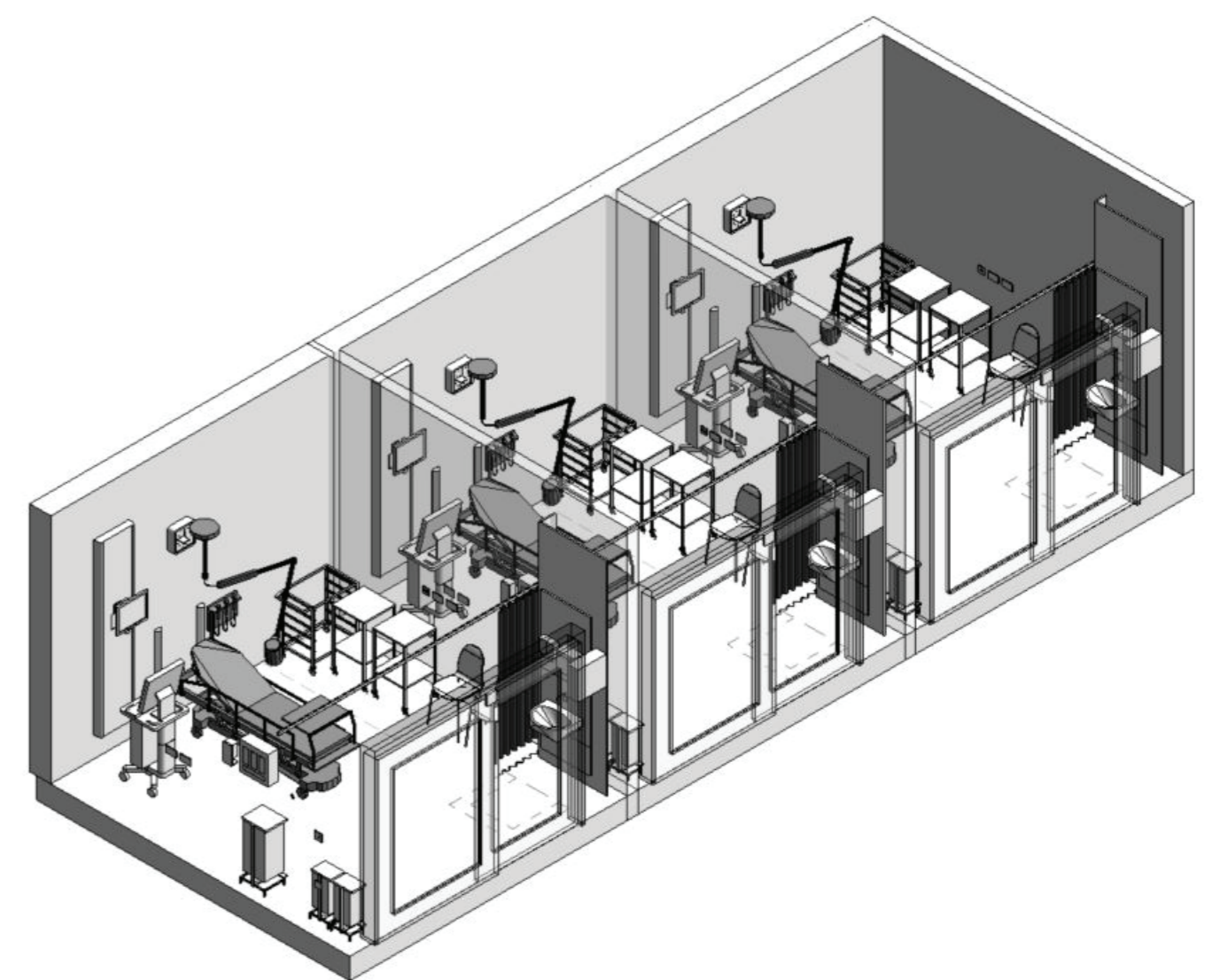

Relocated Urgent Treatment Centre

Key	
<span style="color: red;">■</span>	New building
<span style="color: grey;">■</span>	Existing building
<span style="color: orange;">■</span>	Building refurbished



# Our Redevelopment Plans

## Hemel Hempstead Hospital

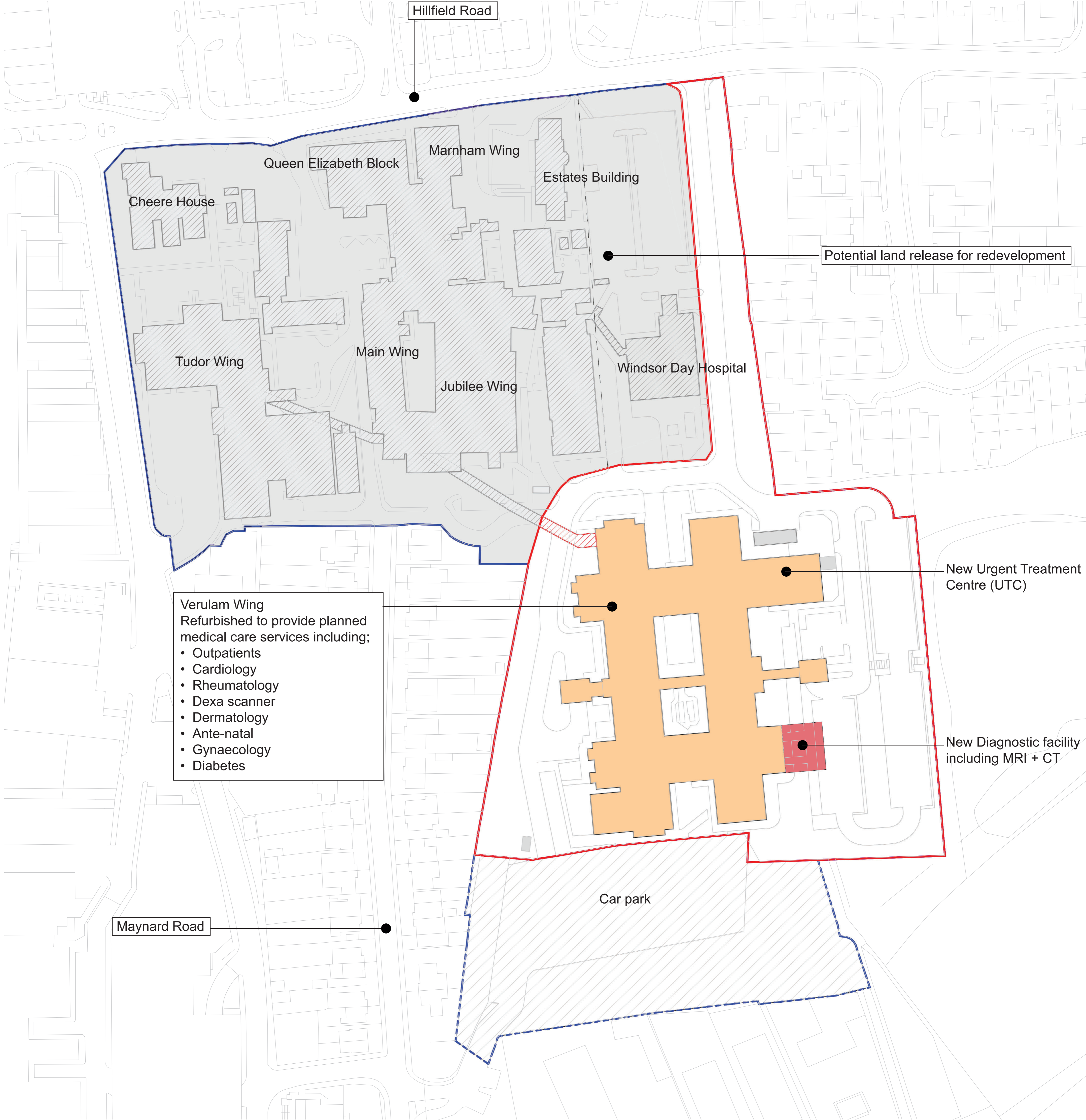

Verulam Wing  
 Refurbished to provide planned medical care services including;

- Outpatients
- Cardiology
- Rheumatology
- Dexa scanner
- Dermatology
- Ante-natal
- Gynaecology
- Diabetes

New Urgent Treatment Centre (UTC)

New Diagnostic facility including MRI + CT

Potential land release for redevelopment

Car park

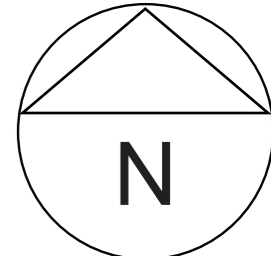

Key	
<span style="display:inline-block; width:10px; height:10px; background-color:red; border:1px solid black;"></span>	New building
<span style="display:inline-block; width:10px; height:10px; background-color:lightgrey; border:1px solid black;"></span>	Existing building
<span style="display:inline-block; width:10px; height:10px; background-color:orange; border:1px solid black;"></span>	Building refurbished



# Our Redevelopment Plans

## St Albans City Hospital

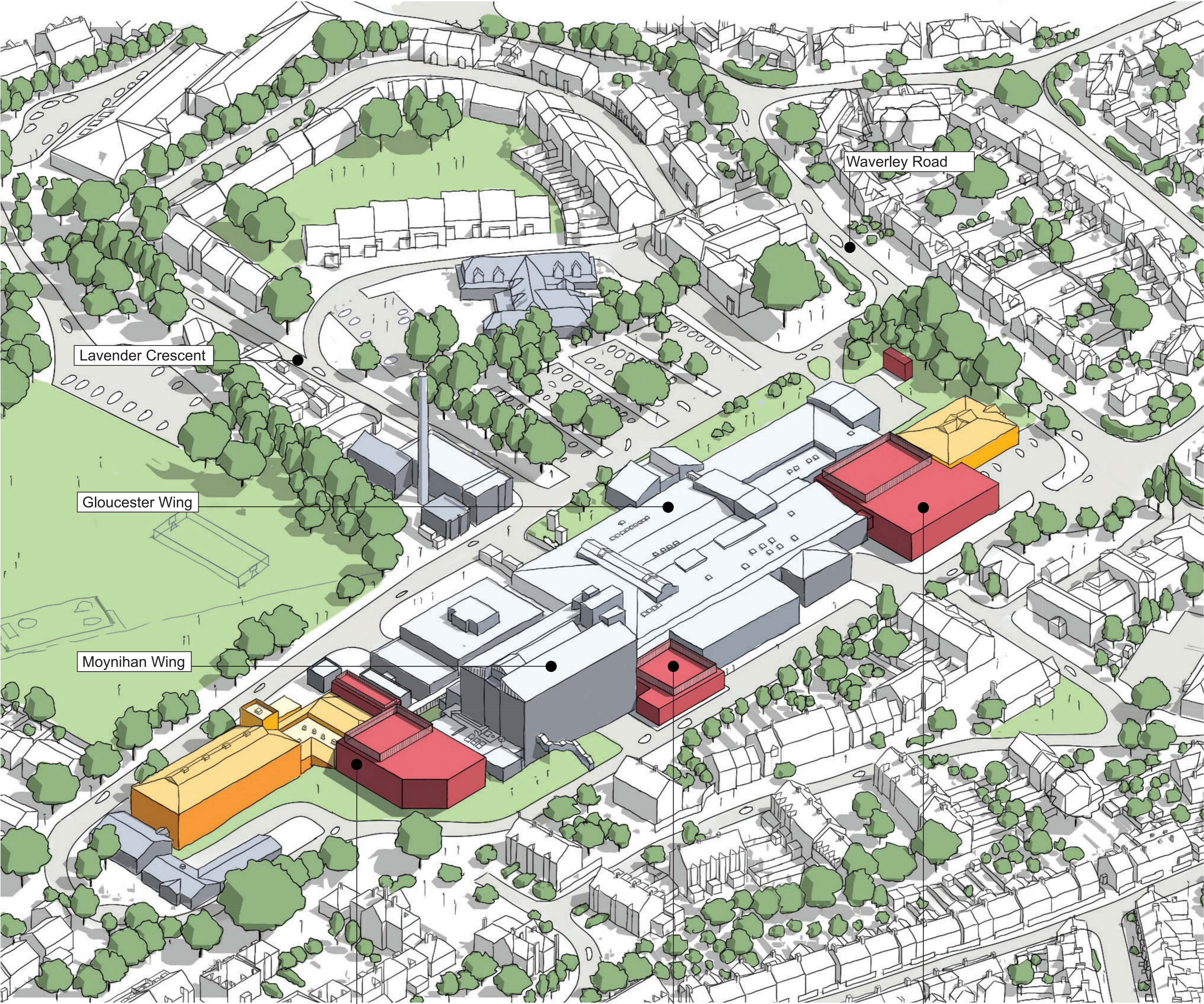

**Indicative 3D models**  
New facilities



New Diagnostic Centre

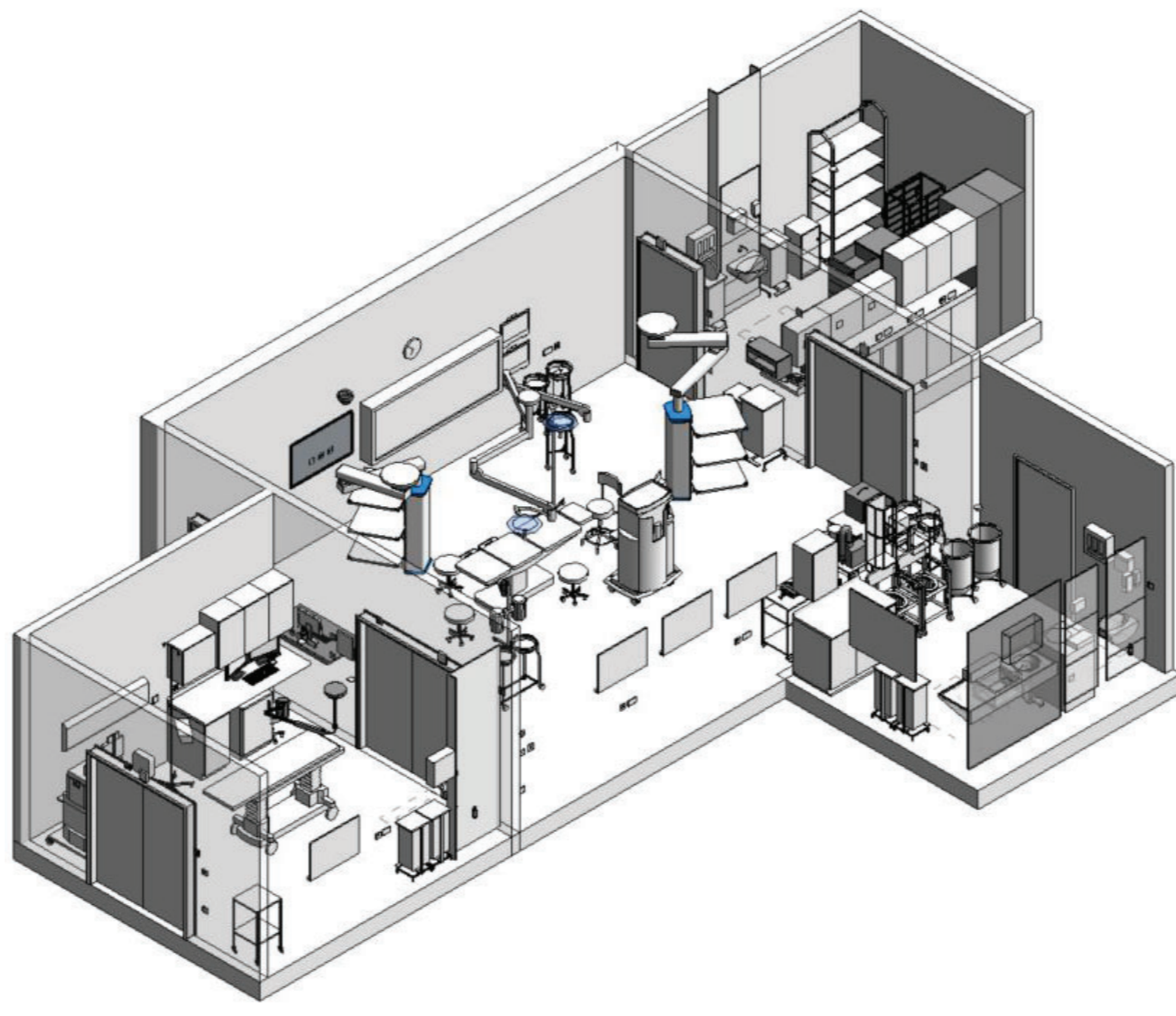

New Operating Theatre

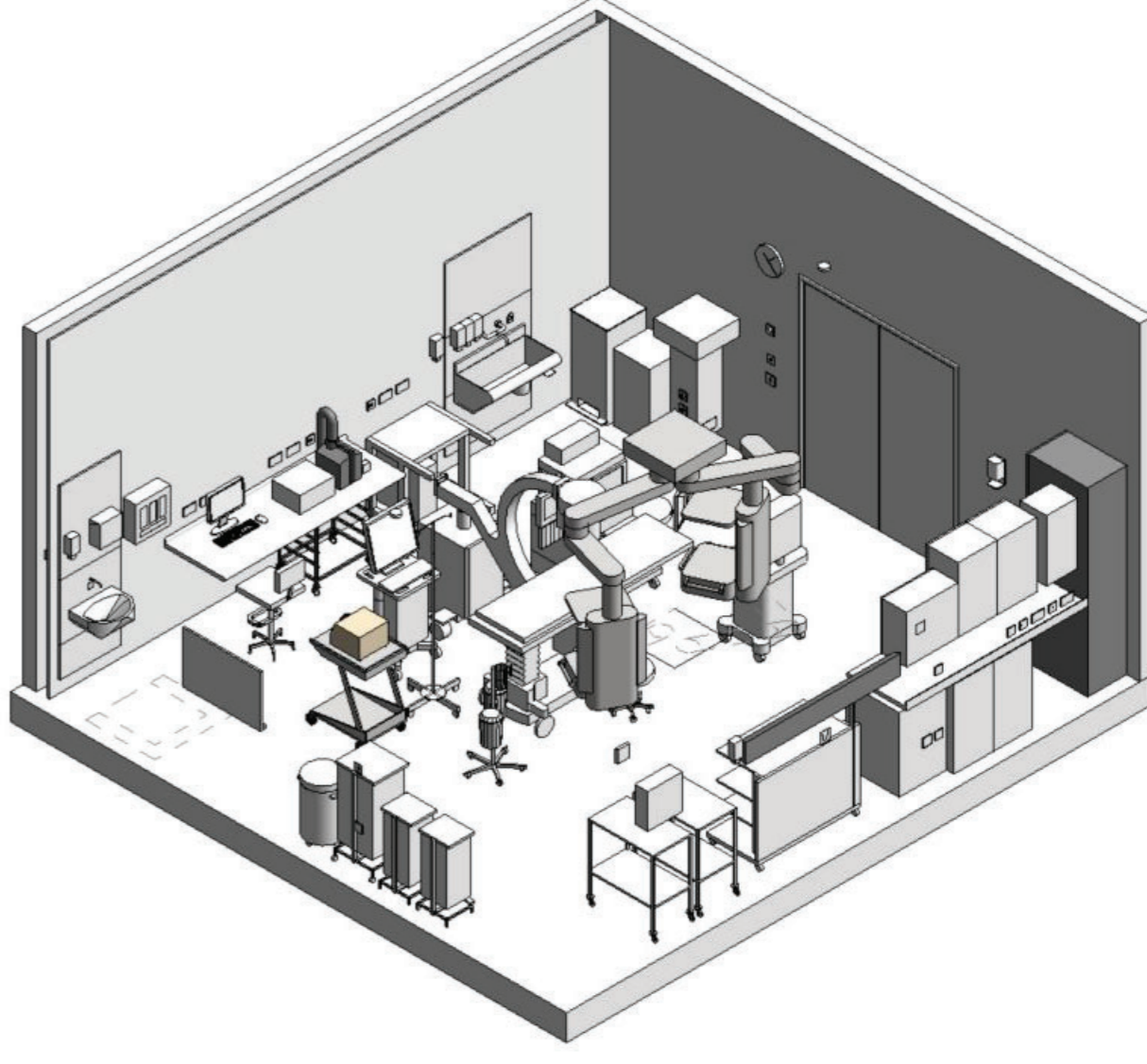

New Endoscopy Centre

Key	
<span style="color: red;">■</span>	New building
<span style="color: grey;">■</span>	Existing building
<span style="color: yellow;">■</span>	Building refurbished



# Our Redevelopment Plans

## St Albans City Hospital

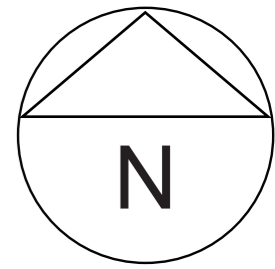

Key	
<span style="color: red;">■</span>	New building
<span style="color: grey;">■</span>	Existing building
<span style="color: yellow;">■</span>	Full refurbishment
<span style="color: orange;">■</span>	Partial refurbishment